



Hello!

Thank you for your interest in our quality range of greenhouses. Winter Gardenz has been family owned and operated for over 13 years, and we take great pride in creating award-winning greenhouses loved by commercial growers, horticulturists, and gardeners alike.

Our greenhouses are designed and manufactured in New Zealand using practical and proven construction methods and materials that will stand the test of time. When you buy a Winter Gardenz Greenhouse, you can be confident that you are purchasing a quality greenhouse that will bring you many years of satisfaction, with our 10 year guarantee for polycarbonate and 25 year guarantee for glass greenhouses.

Whether you are a backyard-gardener or a commercial grower, Winter Gardenz has the right greenhouse for you, as we offer the largest range of greenhouses in New Zealand. We also offer a full range of greenhouse accessories, including shade covers, ventilation, shelving, and staging.

To have a closer look and see what makes our greenhouses stand out from the rest, please feel free to visit one of our retailers in the attached list. All our retailers have an 8x8ft greenhouse on display, and several have a 6x8ft display as well.

If you have any questions, please don't hesitate to get in touch with our helpful team. You can place your order either using the enclosed form, on our website, or through your local retailer.

Yours sincerely,

**The Winter Gardenz Team**

# GREENHOUSE BUYER'S GUIDE



**If you are considering buying a Greenhouse it pays to do your research and ask the right questions. Such as...**

## **Where is the Greenhouse made?**

Is it manufactured locally or imported? Locally made Greenhouses are often better suited to local conditions (i.e. wind, sun, hail, snow, rain, earthquakes etc.), while imported Greenhouses are generally mass-produced with little consideration for local conditions. Imported Greenhouses also tend to be made at very low cost from low-quality materials to provide a good profit margin for the vendor and may fail significantly sooner than a higher quality, locally produced Greenhouse.

## **What sort of guarantee does the Greenhouse have?**

When you buy a Greenhouse, you want peace of mind that it will last for many years, and that you can have it easily replaced if it does not. Ask about the details of any guarantees offered, ensuring that the glazing is also covered by the guarantee. Find out how long the company has been in business and consider the likelihood of them staying in business for after sales support and fulfilment of any guarantees.

## **What size Greenhouse will suit me?**

The best way to choose the right sized Greenhouse is to step inside a few. Even if you whip out the tape measure, attempting to visualise the size of a Greenhouse from a list of dimensions is no substitute for seeing it in person - walking inside a few different sizes will help you to easily establish the right size for its contents.

Spend some time planning a rough layout of your Greenhouse - consider shelving and storage needs, as well as fully grown plant dimensions. In addition to width and length, consider the height of your greenhouse at both the peak and the eaves to ensure you can accommodate your chosen plants. Experience a Winter Gardenz display near you.

## **What glazing will best suit my conditions?**

There are three main glazing options available for your Greenhouse, each with their own advantages and disadvantages: Glass, polycarbonate, and polyethylene.

Glass looks great and lasts the longest, though it is not as well suited to colder, frost-prone regions as polycarbonate.

Premium-grade Polycarbonate will last 16-20+ years and provides superior growing results, thermal efficiency and frost protection, though it comes with a premium-grade price.

Polyethylene, a flexible plastic film, offers a lower cost option per square meter, though it will need replacing after approximately 3-5 years.

Whichever option you choose, a high-quality product from a reputable manufacturer will last longer and perform better than cheap, non-branded glazing products.

## **Do they specialise in Greenhouses?**

It is always better to buy from a company specialised in Greenhouses over a general importer or merchant trader. A specialist company will have a deeper knowledge base, and they will offer more reliable assistance in choosing the right Greenhouse for you, and with after sales support.

## **Does the Greenhouse come with good assembly instructions?**

Ask to see the instructions yourself - they should be written in plain English with a clear step-by-step process. You should be able to construct your Greenhouse without any specialised skills, tools, or equipment.

If the instructions are unclear, or you would rather not assemble the Greenhouse yourself, ask if they provide an installation service in your area.

## **Replacement parts, accessories and local support...are they available?**

If you require replacement parts, or something does not fit as it should, will the company be able to assist? Are additional accessories such as vents, shade-covers and shelving available, and can they be fitted to your Greenhouse after it has been fully assembled and used?

## **Our best top tips...**

1. Don't buy anything you haven't seen standing
2. Be cautious - if the price seems too good to be true, it probably is.
3. Talk to people you know who own Greenhouses.
4. Take time and plan the size you require.
5. Compare, research and be cautious if it's cheap!

There are many cheap, poor-quality Greenhouses imported into New Zealand every year, and most of them do not last more than 18 months.

## **You get what you pay for.**



PHONE 0800 946 837  
WINTERGARDENZ.CO.NZ



Winter  
Gardenz





Winter  
Gardenz™

QUALITY NEW ZEALAND MADE  
**GREENHOUSE RANGE**



**10**

**YEARS**

POLY & SHADE GUARANTEE

**25**

**YEARS**

GLASS GUARANTEE

**NZ**

**MADE**

GREENHOUSES



**NO PANEL**

BLOWOUTS



**RESISTANT**

QUALITY MATERIALS



**150K/HR**

WIND RATING

Leading manufacturer of innovative, award-winning quality greenhouses & systems

[www.WinterGardenz.co.nz](http://www.WinterGardenz.co.nz)



# STANDARD RESIDENTIAL SIZE RANGE

NZ'S LARGEST RANGE OF QUALITY GREENHOUSES

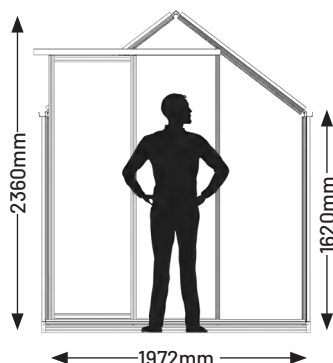

6FT SERIES

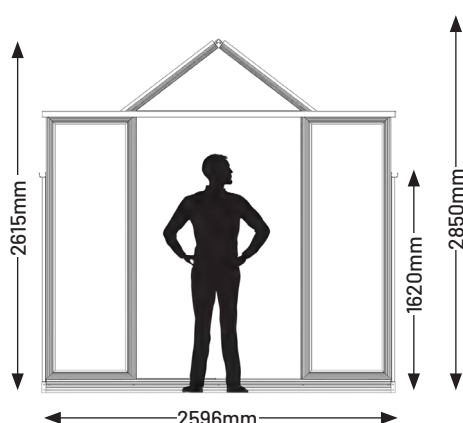

8FT SERIES

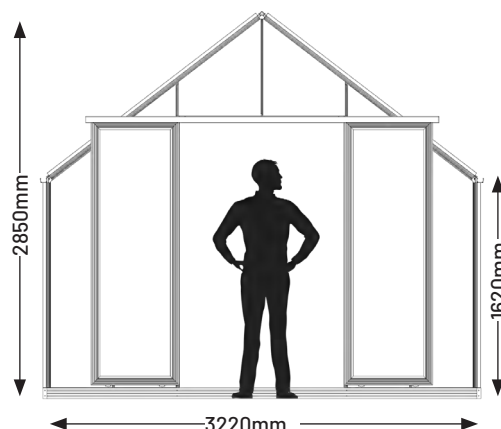

10FT SERIES

## 6X6 GREENHOUSES

W 1972mm x L 1972mm. 1 door & 2 roof vents

6mm Polycarbonate PG0606H-PC6

4mm Safety Glass PG0606H-TG4

Shade Mesh PG0606H-SM5

## 8X6 GREENHOUSES

W 2596mm x L 1972mm. 2 sliding doors & 2 roof vents

6mm Polycarbonate PG0806H-PC6

4mm Safety Glass PG0806H-TG4

Shade Mesh PG0806H-SM5

## 10X8 GREENHOUSES

W 3220mm x L 2596mm. 2 sliding doors & 4 roof vents

6mm Polycarbonate UG1008H-PC6

4mm Safety Glass UG1008H-TG4

Shade Mesh UG1008H-SM5

## 6X8 GREENHOUSES

W 1972mm x L 2596mm. 1 door & 2 roof vents

6mm Polycarbonate PG0608H-PC6

4mm Safety Glass PG0608H-TG4

Shade Mesh PG0608H-SM5

## 8X8 GREENHOUSES

W 2596mm x L 2596mm. 2 sliding doors & 2 roof vents

6mm Polycarbonate PG0808H-PC6

4mm Safety Glass PG0808H-TG4

Shade Mesh PG0808H-SM5

## 10X10 GREENHOUSES

W 3220mm x L 3220mm. 2 sliding doors & 4 roof vents

6mm Polycarbonate UG1010H-PC6

4mm Safety Glass UG1010H-TG4

Shade Mesh UG1010H-SM5

## 6X10 GREENHOUSES

W 1972mm x L 3220mm. 1 door & 2 roof vents

6mm Polycarbonate PG0610H-PC6

4mm Safety Glass PG0610H-TG4

Shade Mesh PG0610H-SM5

## 8X10 GREENHOUSES

W 2596mm x L 3220mm. 2 sliding doors & 2 roof vents

6mm Polycarbonate PG0810H-PC6

4mm Safety Glass PG0810H-TG4

Shade Mesh PG0810H-SM5

## 10X12 GREENHOUSES

W 3220mm x L 3844mm. 2 sliding doors & 4 roof vents

6mm Polycarbonate UG1012H-PC6

4mm Safety Glass UG1012H-TG4

Shade Mesh UG1012H-SM5

## 6X12 GREENHOUSES

W 1972mm x L 3844mm. 1 door & 4 roof vents

6mm Polycarbonate PG0612H-PC6

4mm Safety Glass PG0612H-TG4

Shade Mesh PG0612H-SM5

## 8X12 GREENHOUSES

W 2596mm x L 3844mm. 2 sliding doors & 4 roof vents

6mm Polycarbonate PG0812H-PC6

4mm Safety Glass PG0812H-TG4

Shade Mesh PG0812H-SM5

## 10X16 GREENHOUSES

W 3220mm x L 5138mm. 2 sliding doors & 6 roof vents

6mm Polycarbonate UG1016H-PC6

4mm Safety Glass UG1016H-TG4

Shade Mesh UG1016H-SM5

## 6X16 GREENHOUSES

W 1972mm x L 5138mm. 1 door & 6 roof vents

6mm Polycarbonate PG0616H-PC6

4mm Safety Glass PG0616H-TG4

Shade Mesh PG0616H-SM5

## 8X16 GREENHOUSES

W 2596mm x L 5138mm. 2 sliding doors & 6 roof vents

6mm Polycarbonate PG0816H-PC6

4mm Safety Glass PG0816H-TG4

Shade Mesh PG0816H-SM5

## 10X20 GREENHOUSES

W 3220mm x L 6386mm. 2 sliding doors & 8 roof vents

6mm Polycarbonate UG1020H-PC6

4mm Safety Glass UG1020H-TG4

Shade Mesh UG1020H-SM5

## 6X20 GREENHOUSES

W 1972mm x L 6386mm. 1 door & 8 roof vents

6mm Polycarbonate PG0620H-PC6

4mm Safety Glass PG0620H-TG4

Shade Mesh PG0620H-SM5

## 8X20 GREENHOUSES

W 2596mm x L 6386mm. 2 sliding doors & 6 roof vents

6mm Polycarbonate PG0820H-PC6

4mm Safety Glass PG0820H-TG4

Shade Mesh PG0820H-SM5

## 10X24 GREENHOUSES

W 3220mm x L 7680mm. 2 sliding doors & 8 roof vents

6mm Polycarbonate UG1024H-PC6

4mm Safety Glass UG1024H-TG4

Shade Mesh UG1024H-SM5

## 6X24 GREENHOUSES

W 1972mm x L 7680mm. 1 door & 8 roof vents

6mm Polycarbonate PG0624H-PC6

4mm Safety Glass PG0624H-TG4

Shade Mesh PG0624H-SM5

## 8X24 GREENHOUSES

W 2596mm x L 7680mm. 2 sliding doors & 8 roof vents

6mm Polycarbonate PG0824H-PC6

4mm Safety Glass PG0824H-TG4

Shade Mesh PG0824H-SM5

## 10X36 GREENHOUSES

W 3220mm x L 11424mm. 2 sliding doors & 12 roof vents

6mm Polycarbonate UG1036H-PC6

4mm Safety Glass UG1036H-TG4

Shade Mesh UG1036H-SM5

Other sizes available. \*Please use mm dimension for base/foundation layout. Shade houses do not come with roof vents.

# UNIQUE FEATURES

## WHY OUR GREENHOUSES STAND OUT FROM THE REST

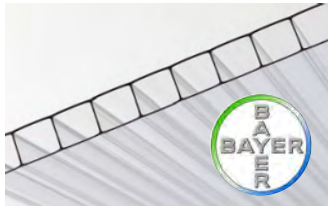

### POLYCARBONATE

#### 6mm Twinwall

Keeps the warmth in and the frosts out, protecting your plants during the colder months. Covered by a 10-yr warranty against breakage and panel blowouts!

The practical choice!



### SAFETY GLASS

#### 4mm Toughened

Glass provides superior clarity and longevity and is now significantly stronger. Made to NZ safety standards, this glass can take almost anything you can throw at it. Includes 25yr glazing warranty.

Looks stunning!



### SHADE MESH

#### Expanded Aluminium

The durable aluminium mesh screen blocks out the harsh sun (approx 50%) while providing adequate air-flow and ventilation to promote optimal plant growth.

Includes 15-yr warranty.

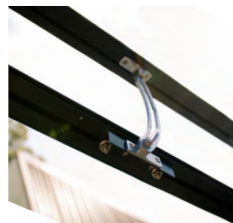

### OPENING VENTS

Adjustable opening roof vents provide adequate ventilation and temperature control. Automatic vent openers are also available, pictured below.

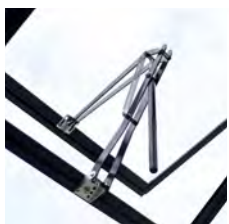

### DURABLE

Long lasting, powder coated finish in black with Dulux Powder coat. Looks great and requires minimal maintenance. Covered by Dulux non-fade warranty.



### ALUMINIUM FRAME

Heavy duty aluminium frame to provide years of trouble free service with minimal maintenance.

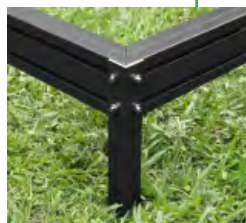

### BASE INCLUDED

All Winter Gardenz Greenhouses come with a strong aluminium base and have foundation mounting options to suit most applications.

### SUPERIOR DESIGN AND CONSTRUCTION

Winter Gardenz unique design delivers superior strength and durability. There is no other that comes close.



### RAINWATER GUTTER SYSTEM

Unique gutter system for collecting rain water.

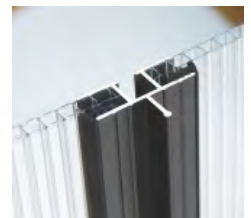

### RUBBER BEADING

Unique rubber bead sealing system designed to hold the glazing panels firmly in place while adding significant strength to the overall structure.

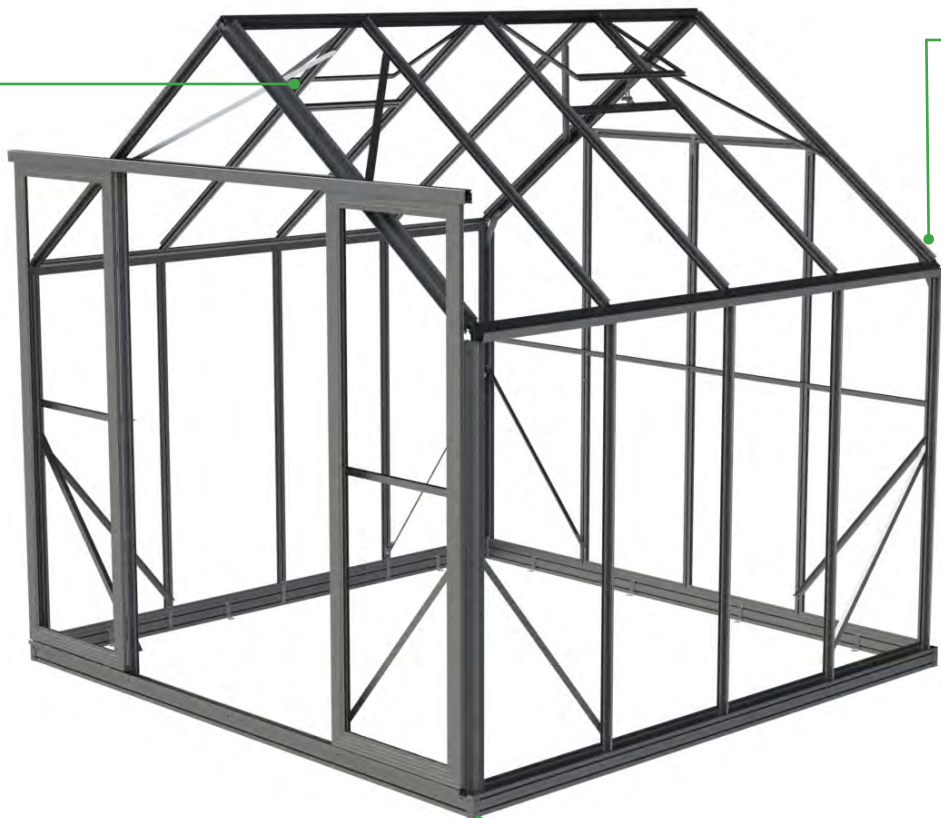

## HOW TO CHOOSE THE GREENHOUSE FOR YOU?

STEP 1

Choose a frame width. 6ft, 8ft, or 10ft series. This also determines the height of Greenhouse.

STEP 2

Choose the length. 6ft, 8ft, 10ft or 12 ft right up to 36ft or longer. We can also do custom lengths.

STEP 3

Choose the Glazing. Toughened Safety Glass, Shade Mesh, or Insulating Polycarbonate

# ELITE SERIES GREENHOUSES

## TRADITIONAL STYLE - SUPERIOR QUALITY



### RAIN HARVESTING

Gutters and downpipe connectors are supplied to enable water collection.

**WINTER GARDENZ ELITE RANGE** is constructed using only the best materials and design systems to ensure structural integrity of the greenhouse, while also delivering elegance and functionality.



### FINIALS & CRESTINGS

These are optional and considered a lovely finish if you prefer the Victorian style of Greenhouse.

### OPENING VENTS

Temperature controlled vents open and close automatically to assist in maintaining the optimum temperature.

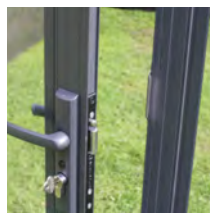

### FULL-HEIGHT DOORS

Hinged, double opening doors with **quality door handles** and locks.

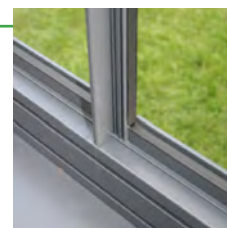
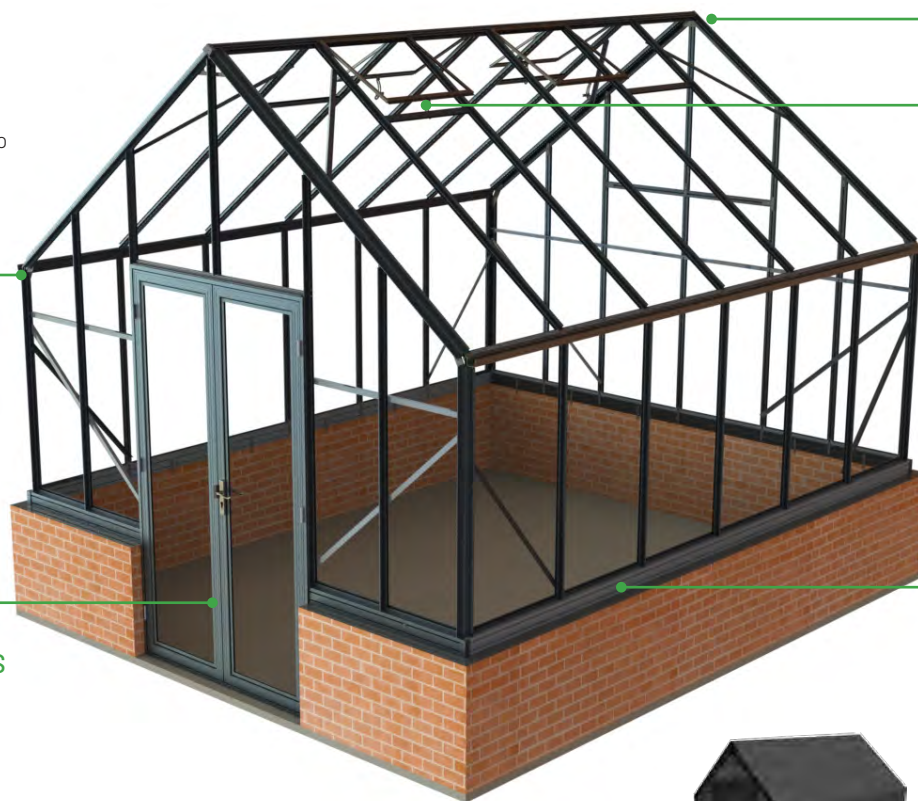

### SHADE SYSTEM

The shade-cover system provides **protection for your plants** in the hotter months and is removable when not required.

Superior design & construction  
The unique design delivers superior **strength and durability**, with minimal maintenance required.

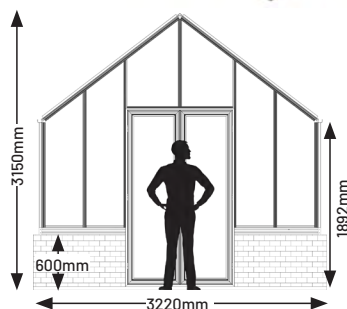
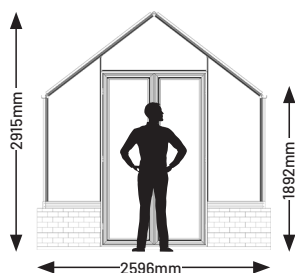

#### 8X8 ELITE GREENHOUSE UG0808-ES

W 2596 x L 2596 x H 2915mm

- Double opening, lockable doors, 2x vents

#### 8X10 ELITE GREENHOUSE UG0810-ES

W 2596 x L 3220 x H 2915mm

- Double opening, lockable doors, 2x vents

#### 8X12 ELITE GREENHOUSE UG0812-ES

W 2596 x L 3844 x H 2915mm

- Double opening, lockable doors, 4x vents

#### 8X16 ELITE GREENHOUSE UG0816-ES

W 2596 x L 5138 x H 2915mm

- Double opening, lockable doors, 6x vents

#### 8X20 ELITE GREENHOUSE UG0820-ES

W 2596 x L 6386 x H 2915mm

- Double opening, lockable doors, 6x vents

#### 8X24 ELITE GREENHOUSE UG0824-ES

W 2596 x L 7680 x H 2915mm

- Double opening, lockable doors, 8x vents

#### 10X10 ELITE GREENHOUSE UG1010-ES

W 3220 x L 3220 x H 3150mm

- Double opening, lockable doors, 2x vents

#### 10X12 ELITE GREENHOUSE UG1012-ES

W 3220 x L 3844 x H 3150mm

- Double opening, lockable doors, 4x vents

#### 10X16 ELITE GREENHOUSE UG1016-ES

W 3220 x L 5138 x H 3150mm

- Double opening, lockable doors, 6x vents

#### 10X20 ELITE GREENHOUSE UG1020-ES

W 3220 x L 6386 x H 3150mm

- Double opening, lockable doors, 6x vents

#### 10X24 ELITE GREENHOUSE UG1024-ES

W 3220 x L 7680 x H 3150mm

- Double opening, lockable doors, 8x vents

#### 10X36 ELITE GREENHOUSE UG1036-ES

W 3220 x L 11424 x H 3150mm

- Double opening, lockable doors, 12x vents

**All Elite Greenhouses are supplied fully optioned and include the following:**

- ✓ Double-hinged lockable doors
- ✓ 3 tier staging down one side of the greenhouse
- ✓ Shade cover system to protect plants in summer
- ✓ Glazed with 4mm toughened safety glass
- ✓ Temperature controlled vent openers
- ✓ Gutter system for rain catchment
- ✓ 25-year warranty

\*Custom sizes also available. Typical foundation plan is provided with each kitset. Brick wall shown is for illustration purposes only, it is not included in the kitset.



# MULTIZONE GREENHOUSES

## TWO GROWING ENVIRONMENTS IN ONE STRUCTURE



THE MULTIZONE GROWHOUSE is a **unique and innovative** product that offers the grower the versatility to **grow in just about any climate**.

### SMOOTH SLIDING DOORS

Smooth sliding doors which incorporate a stainless steel bearing roller system - runs effortlessly on its track for years.

### SHADE ZONE FOR HARDENING OFF

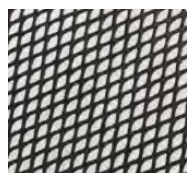

### SHADE MESH

#### Expanded Aluminium

The durable aluminium mesh screen blocks out the harsh sun (approx 50%) while providing adequate air-flow and ventilation to promote optimal plant growth.

### HOT HOUSE ZONE FOR PROPAGATING

### OPENING VENTS

Temperature controlled vents open and close automatically to assist in maintaining the optimum temperature.



### POLYCARBONATE

#### 6mm Twinwall

Keeps the warmth in and the frosts out, protecting your plants during the colder months. Covered by a 10-yr warranty against breakage and panel blowouts!

### INTERNAL WALL

Internal partition wall with sliding doors, glazed with polycarbonate to retain warmth in the hothouse zone.

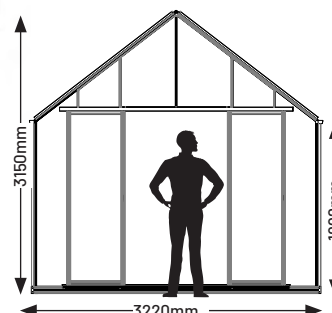

#### ✓ Adaptable design for all seasons

Both Hot-House and Shade-House, in one structure

#### ✓ Rigid aluminium shade panels in the Shade-House zone

Blocks out the harsh sun and wind. Also suitable for insect and pest protection

#### ✓ Thermally efficient polycarbonate glazing in the Hot-House zone

Keeps the warmth in and the frosts out

#### ✓ Strong and durable frame

Practical and tough, requiring minimal maintenance

**Winter Gardenz MultiZone Greenhouses** are designed to provide growers with the best of both worlds: an enclosed Hot-House with adjoining Shade-House, separated by an internal partition wall and sliding door, to create the two zones in one structure.

**Our MultiZone Growhouses** are constructed from the same durable frame as our popular award winning Greenhouse range, which provides a strong, practical and long lasting structure, requiring very little maintenance.

**The Shade-House** zone is designed to protect your plants from the heat of direct sun-light, damage from high wind, pests & insects, while still providing adequate ventilation and air movement in the hot months. It is perfect for light-sensitive plants such as orchids, azaleas and ferns, etc., but is more commonly used for 'Hardening Off' young, delicate plants that have been propagated in the Hot-House Zone.

**The Hot-House** zone is glazed with 6mm twin-wall polycarbonate and creates an ideal growing zone for plants and seedlings, especially when the outside temperature cools. This glazing provides superior thermal efficiency, keeping the warmth in and the frost out.

#### 10X12 MULTIZONE GROWHOUSE UG1012XH-MZ

W 3220 x L 3890 x H 3150mm

- Integrated 6ft hothouse with 6ft shade house
- 2x double sliding doors, internal partition wall, 2x vents

#### 10X20 MULTIZONE GROWHOUSE UG1020XH-MZ

W 3220 x L 6386 x H 3150mm

- Integrated 10ft hothouse with 10ft shade house
- 2x double sliding doors, internal partition wall, 4x vents

#### 10X16 MULTIZONE GROWHOUSE UG1016XH-MZ

W 3220 x L 5138 x H 3150mm

- Integrated 8ft hothouse with 8ft shade house
- 2x double sliding doors, internal partition wall, 4x vents

#### 10X24 MULTIZONE GROWHOUSE UG1024XH-MZ

W 3220 x L 7634 x H 3150mm

- Integrated 12ft hothouse with 12ft shade house
- 2x double sliding doors, internal partition wall, 4x vents

**Unique and practical design, that looks great and provides a versatile and flexible approach to year-round growing.**

\*Custom sizes and glass option available instead of polycarbonate.

# SHELVING, STAGING, AND ACCESSORIES

## PRODUCTS TO MAKE THE MOST OF YOUR GREENHOUSE



### STANDING SHELVING

360mm depth, 2-tiers

- Aluminium construction with stainless steel fasteners
- Strong, durable and low maintenance.

Potting Bench 900mm wide PB0900  
Potting Bench 1200mm wide PB1200



### WALL MOUNTED SHELVING

300mm depth

- Aluminium construction with stainless steel fasteners
- Attach at any height, easy to install.

Wall Shelving 900mm wide HS0900  
Wall Shelving 1200mm wide HS1200  
Wall Shelving 1500mm wide HS1500

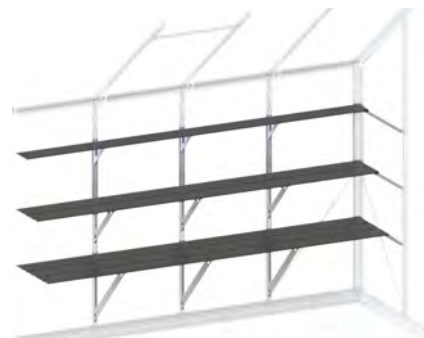

### 3-TIER STAGING

150, 300 and 450 mm depth

- Maximise growing space

Staging 6ft Long ST06  
Staging 8ft Long ST08  
Staging 10ft Long ST10  
Staging 12ft Long ST12

\*Single shelves also available in all sizes



### SHELVING BRACKETS

- Cost effective shelving
- Sold in pairs with fasteners

Shelving Brackets 150mm wide SB150  
Shelving Brackets 300mm wide SB300  
Shelving Brackets 450mm wide SB450

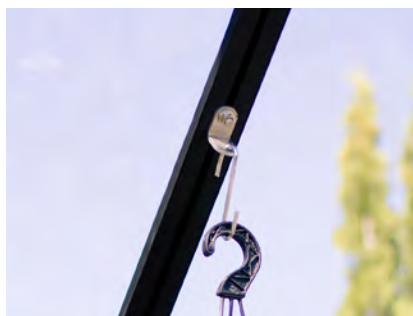

### HANGING BRACKETS

- Create vertical or horizontal string lines, or use for hanging plants

Hanging Brackets 6pk HBA6



### AUTO VENT OPENERS

- Ideal for Summer
- Opens when it's hot and closes when it's cold.
- Strong, durable and reliable.
- No power required, easy to install.

Auto Vent Opener AV01



### LOUVRE VENT KITS

- Designed to be installed into the side walls of the greenhouse. Allows cool air to enter, while hot and stuffy air ventilates through the roof.

Louvre Vent Kit (Poly) LVK3-PC6  
Louvre Vent Kit (Retro Poly) LVK3-PC6-RETRO  
Louvre Vent Kit (Glass) LVK3-TG4



### SHADE COVER KITS

- Protect plants from the sun's harsh rays (70% block-out).
- Reduces the inside temperature to prevent plants from overheating in the hot sun.
- Supported in position with a durable aluminium frame system.
- Various sizes available.



### MESH SCREEN DOOR

- Allow more air to get in. A screen door on your glass or polycarbonate greenhouse is another option to help with airflow inside while keeping pests out.

Mesh Screen Door SD1953  
Top Door Extension L621-1900  
(for 6ft models only)



# 12ft SERIES

THE LARGEST OF OUR RESIDENTIAL SERIES GREENHOUSES



Winter Gardenz' stunning new 12ft series is the largest in the residential greenhouse range, standing at nearly 4m tall (2.4m to the eave) and offering a spacious 3.8m width over a range of lengths. The 12ft series offers a significant step up from the 8ft/10ft Elite range, both in terms of height and interior living space.

Built to Winter Gardenz exacting standards, the 12ft series is constructed from durable, quality materials. The aluminium and glass structure is supported by a galvanised steel substructure, and all structural components are powder-coated with a quality Dulux

finish, to provide a low maintenance and easy-clean surface for years to come.

The 12ft series comes with one set of double-hinged lockable doors as standard, and both roof and louvre vents to provide adequate ventilation. Additional doors, vents, and shelving can also be added if required.

The 12ft series is a durable and elegant structure that will stand the test of time.

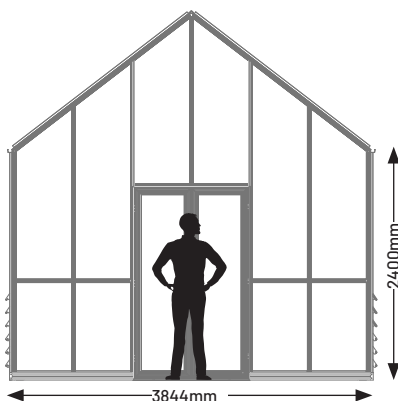

12ft STANDARD

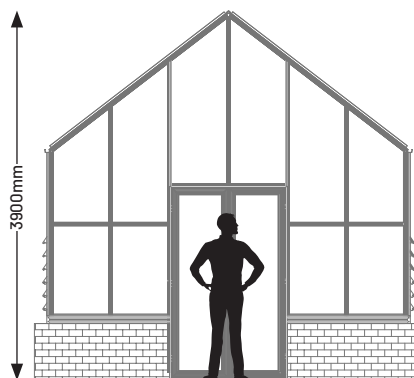

12ft ELITE

**12X16 GREENHOUSE** UG1216-TG4  
W 3844mm x L 5138mm x H 3900mm  
• Double opening, lockable doors  
• 8x roof vents, 4x louvre vents

**12X20 GREENHOUSE** UG1220-TG4  
W 3844mm x L 6386mm x H 3900mm  
• Double opening, lockable doors  
• 8x roof vents, 4x louvre vents

**12X24 GREENHOUSE** UG1224-TG4  
W 3844mm x L 7680mm x H 3900mm  
• Double opening, lockable doors  
• 12x roof vents, 6x louvre vents

**12X30 GREENHOUSE** UG1230-TG4  
W 3844mm x L 9552mm x H 3900mm  
• Double opening, lockable doors  
• 12x roof vents, 6x louvre vents

**12X40 GREENHOUSE** UG1240-TG4  
W 3844mm x L 12718mm x H 3900mm  
• Double opening, lockable doors  
• 16x roof vents, 8x louvre vents

**12X50 GREENHOUSE** UG1250-TG4  
W 3844mm x L 15884mm x H 3900mm  
• Double opening, lockable doors  
• 20x roof vents, 10x louvre vents

\*Other sizes available. Dimensions are approximate. Typical foundation plan is provided with kitset. Brick wall shown not included.

# CUSTOM & ARCHITECTURAL GREENHOUSES

## DESIGNED AND BUILT TO SUIT YOUR REQUIREMENTS



## ARCHITECTURAL

Whether it's an aesthetically pleasing space to entertain and relax in, an effortless way to grow your plants year-round, or just a reason to spend more time outside, our architectural glasshouses allow our clients to enjoy one of life's most simple pleasures - outdoor living that isn't controlled by the weather.

Our architectural Glasshouses make a beautiful modern addition to lifestyle properties, commercial properties, and hospitality venues, providing the ideal space for entertaining and events, all but removing the boundary between people and the natural environment around them.

Our custom architectural glasshouses are bespoke structures made from the highest quality materials using highly innovative and engineered custom designs. From concept, design, and engineering, through to manufacture and construction, we deliver every step of the process with a clear dedication to quality and meticulous attention to detail.

We offer a full range of lengths, widths, and heights to suit each client's specific needs and spatial requirements. We can even alter the roof pitch to achieve optimum growing conditions, create an architectural statement, or simply match the aesthetics of your existing property.

## QUARANTINE AND RESEARCH

In addition to our Greenhouses being ideal for commercial growing operations, the unique design and construction also makes them a suitable structure for Biosecurity, Plant Containment, Test and Research Greenhouses.

Talk to the team at Winter Gardenz to discuss a tailored solution that will suit your requirements and provide years of trouble free service.



AVAILABLE FROM:



NZ 0800 946 837 | AUS 1800 757 610 | [WINTERGARDENZ.CO.NZ](http://WINTERGARDENZ.CO.NZ)